



Henley-in-Arden

Croft Car Park Management

Set-up Costs - £10K

Running Costs - £5K PA

Income - c.£25K PA

OPEN DAYS

2ND KERB

OPENING HOURS

MON	9.00-18.00
TUE	9.00-18.00
WED	9.00-18.00
THUR	9.00-18.00
FRI	9.00-18.00
SAT	9.00-18.00



THE SHOPPERS CAR PARK

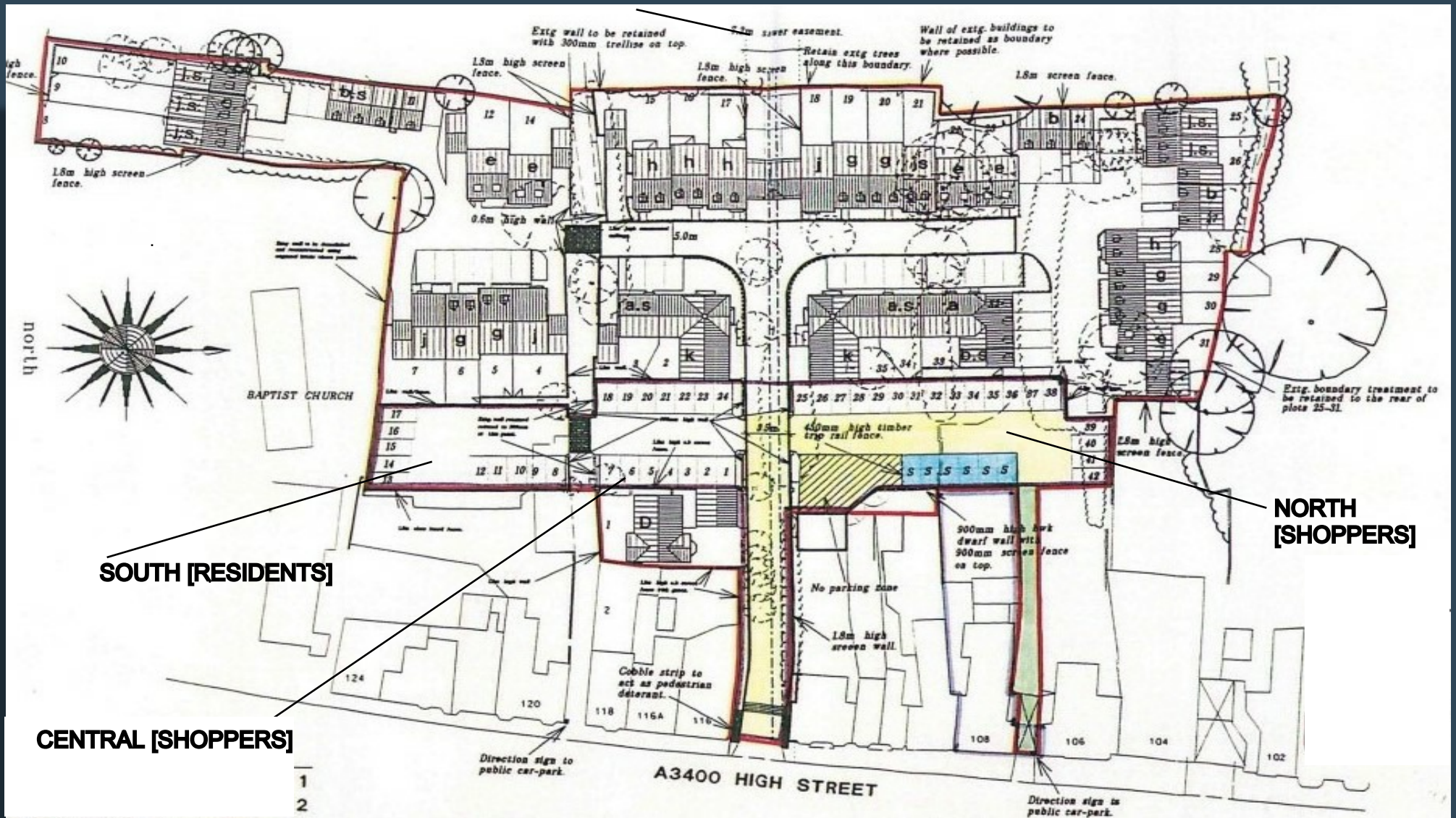

TARIFFS

Shoppers Pay & Display Tariff

Charging tariff Monday – Sunday 08:00 hours - 18:00 hours

Up to 2 hours FREE

Up to 3 hours £2.00

Up to 4 hours £3.00

All day (until 07:59 the following day) £6.00

Charging Evening Tariff Monday – Sunday 18:00 hours – 07:59 hours

Evenings and overnight £1.50

Residents Annual Parking Permits

Proposed at £500.00 pa. [Limited spaces]

COSTS - KERB

GETTING STARTED: KERB FEES

KERB Setup	£750.00 Ex. Vat
Remote support	£0.00
On-site visits by KERB, 1 Per Month	£0.00
Signage Design by KERB	£0.00
Signage Print & Installation	Paid by car park owner
KERB Software Service Fee	£1 Per Month, Per Bay Ex. Vat
Transaction Fee	10% Ex. Vat

Notes

- Onboarding of tenants, ongoing customer support and marketing is included in KERB's monthly service fee.

COSTS SDC



Metric ELITE LS Payment Terminal

METRIC Elite LS

- ✓ 4,000 Ticket Capacity (per roll)
- ✓ 15 Coin Acceptance
- ✓ 2.5mm steel casework with reinforced armour plated vault protection. 9mm reinforced vault door with no external lock, KABA locking mechanisms
- ✓ Electronic locking vault & keys
- ✓ Six litre cash box supplied with machine
- ✓ 5.7" display screen
- ✓ Full illumination of customer interface zones
- ✓ Colour: Blue
- ✓ Power: Mains
- ✓ Ground Mounting Cradle

Ticket Machine	£5,200.00
Signage	£1,500.00
Markings	£1,500.00
Enforcement	NIL

